

New Middle School Student Information



Back to School Topics

- Attendance
- Classroom & Office Locations
- Faculty Additions
- The Rotating Schedule
- FACTS SIS
- Laptops/OneNote

- Student E-Mail Accounts
- Lockers
- Parent Teacher Fellowship
- Car Line (drop off and pick-up)
- Helpful Tips for Parents

Attendance & Tardies



- “10% Rule” Applies for absences (no “excused” or “unexcused”): 8 or more absences in a class during one semester results in a 2 point deduction from semester grade.
- Sick student should be fever free for 24 hours before returning to school.
- A doctor’s note turned into the middle school office upon return from absence is highly encouraged.
- Tardies: 4 unexcused tardies per quarter without penalty. A 5th unexcused tardy in a given quarter will result in a detention.

Classroom Locations



*Band in PABC Middle School Theater
 *Performing Arts in PABC Childrens' Theater

Main Building Map 2021-2022

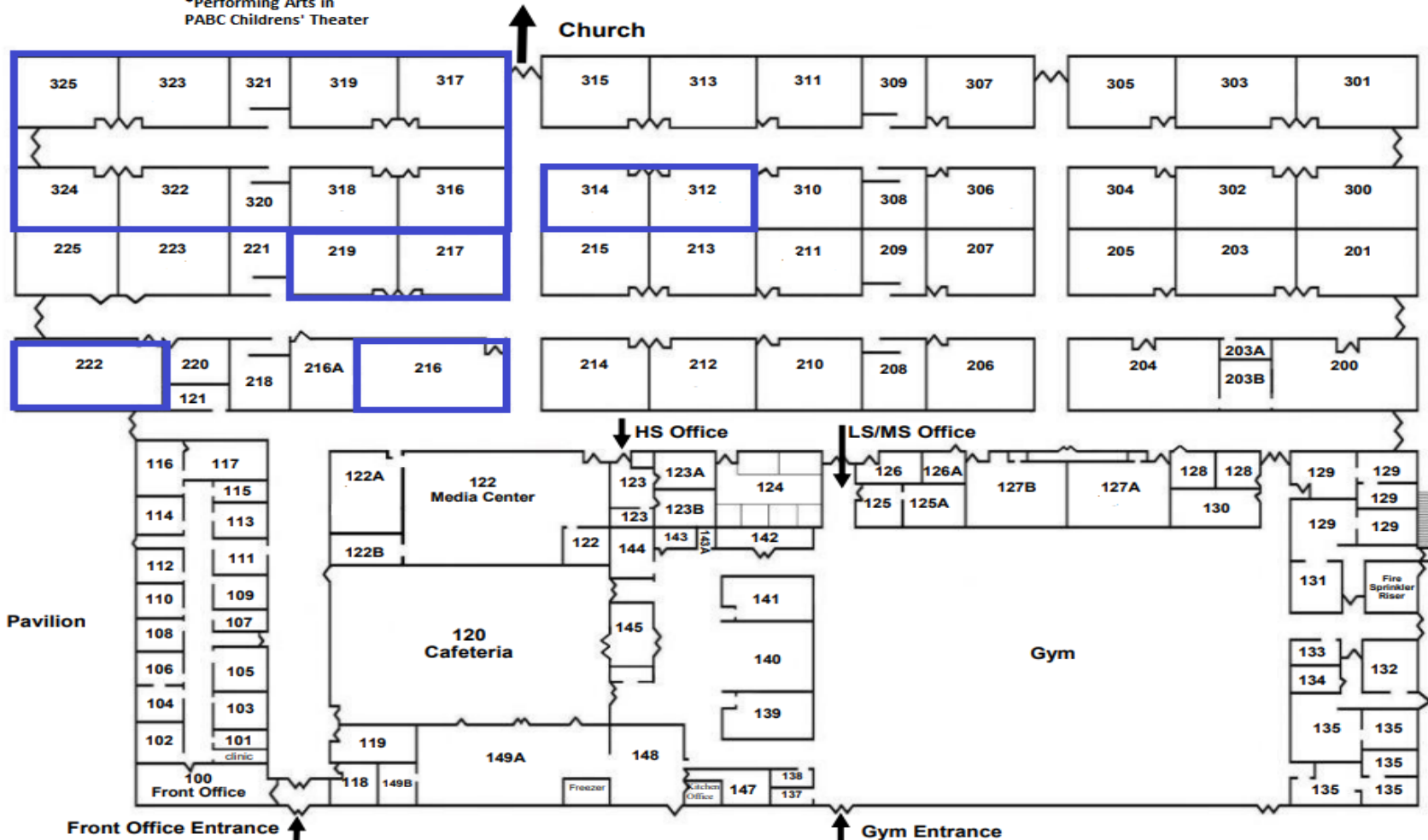

Office Location



- Middle & Lower School Office (room 125)
 - Off hallway to gymnasium
 - Same location as previous years
 - Mrs. Jennifer Palmer Administrative Assistant
 - Mr. Owens' Office (room 126)
 - Enter through LS/MS office

Student Check-Out Procedure



- All MS students will be checked out in Front Office.
- Parents don't need to come back to MS office to check out students.

New Middle School Faculty



- Ms. Baylee Rogers
 - 6th and 7th Grade Math



Rotating 8 Period Schedule



Time	Day A	Day B	Day C	Day D
8:10 - 9:14	1	7	5	3
9:14 - 9:27	break	break	break	break
9:27- 10:27	2	8	6	4
10:31 - 11:31	3	1	7	5
11:35 - 12:35	4	2	8	6
12:35 - 1:10	lunch	lunch	lunch	lunch
1:14 - 2:14	5	3	1	7
2:18 - 3:18	6	4	2	8
3:18 - 3:25	pack-up	pack-up	pack-up	pack-up

Schedule



- 4 day schedule rotation (A, B, C, D) throughout the school year
 - Large schedule signs are posted in three hallway locations
 - Thursdays are chapel day so dress accordingly
 - Middle School will have snack (break) every morning
-

New Middle School Student Information



-Schedules will be open in FACTS SIS at the end of July for students to see their class schedule and teachers.

-Class schedules will include a locker number. Students may not use locks on their lockers.

FACTS SIS



- Student grades, attendance and homework are posted in FACTS SIS for student and parents to view
- Automatic parent e-mail notification sent out for any grade 75 or below

Laptops and OneNote



- All middle school students will be given a laptop device.
 - Student training will be ongoing and expectations clear.
 - Teachers can post class resources for students to OneNote.
 - OneNote is different than FACTS SIS
 - OneNote = classwork, notes, worksheets, videos, announcements, links, etc.
 - FACTS SIS = grades, attendance, homework due dates
-

Student E-mail Accounts



- All middle school students will be given a school e-mail account
 - This account is for communication with administrators and teachers
 - Students are not allowed to change the account domain (Yahoo, Gmail, Hotmail, etc.)
- Students with email, laptop or OneNote issues should email PACS IT Office (itsupport@princeave.org)

Wolverine Welcome

Parent Teacher Fellowship (PTF)



- PTF grade level representatives

6th Grade: Ashley Young (girls), Elizabeth Hutcheson (boys)

7th Grade: Jan Barham (girls), Tara Garland (boys)

8th Grade: Jeanna Kelley (girls), Toni Burns (boys)

- PTF is a great resource for parents with questions (Especially new parents)
 - PTF Representatives meet with principal quarterly to discuss school programs
-

Car Line

School Year 2021-2022



Car Line Procedures School Year 2021-2022 (no change from last year)

Morning Drop Off

Begins at 7:45 a.m.

PACS MORNING DROP OFF

Highway 78

2nd -5th Grade, Middle School and High School drop-off

Cars with Pre-K, Kindergarten, 1st grade and older siblings drop-off

Cars with Pre-K, Kindergarten & 1st grade (only)

Pre-K, K, 1st here.

2nd – 12th grades here

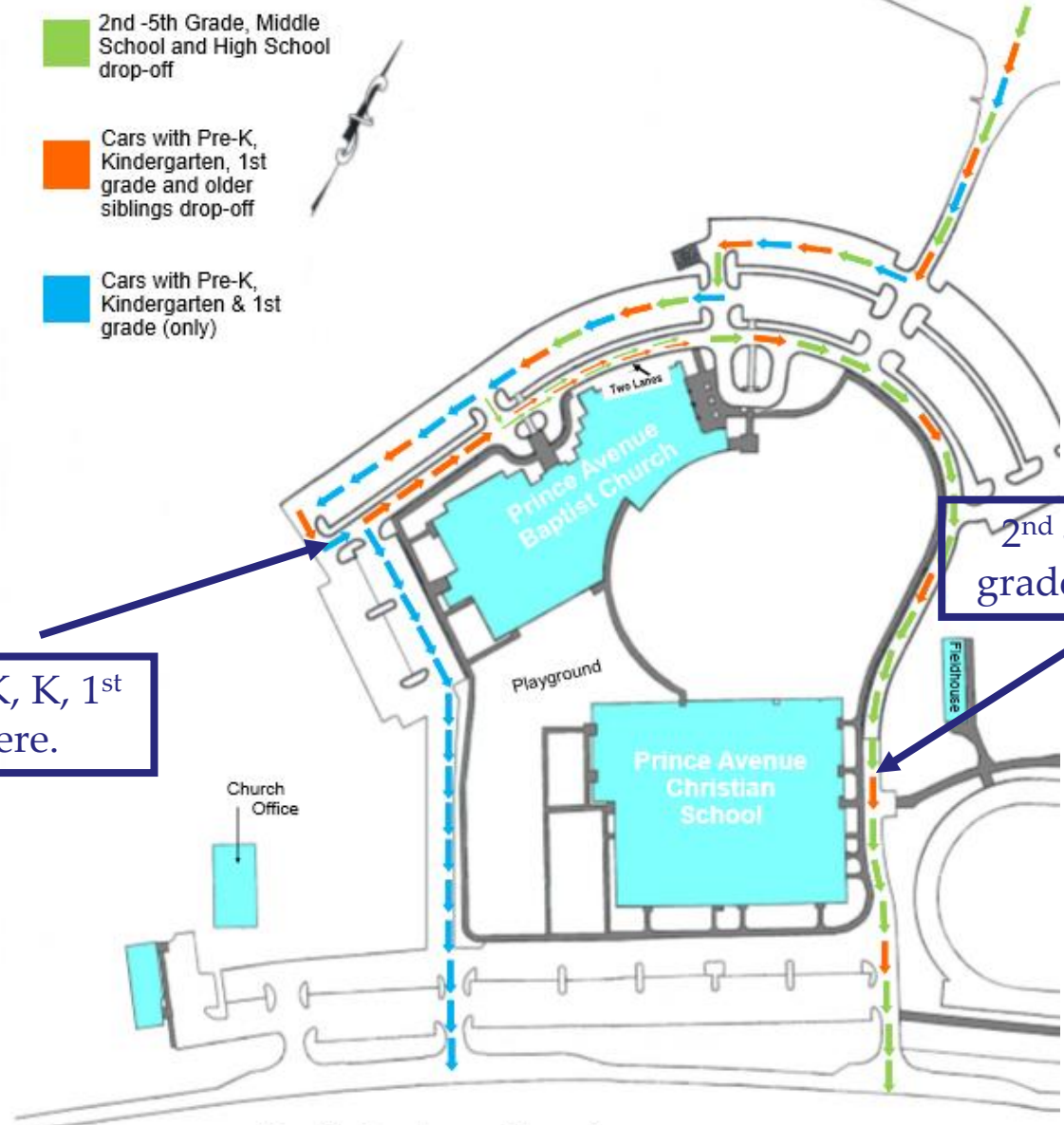

Ruth Jackson Road

Afternoon Pickup

Middle & High with younger sibling(s)
Begins at 3:25 p.m.



A-J "hold here" until 3:25 p.m.

K-Z "hold here" until 3:25 and pickup here

A-J pickup here at main building after 3:25

CLASS TRIPS

6th Grade Savannah Trip



- March 30-April 1, 2022 (Wednesday-Friday)
- Trip Organizer- Mrs. Robin Sosbee
- More information to come in the fall

CLASS TRIPS

7th Grade Ark Encounter and Creation Museum Trip



- March 29-April 1, 2022
- Trip Organizer- Mrs. Mandy Eley



CLASS TRIPS

8th Grade Washington DC Trip



- March 28-April 1, 2022
- Trip Organizer- Mrs. Mandy Scoggins
- More information to come in the fall

Some Tips for Middle School Parents



- The administration and teachers are partnering with you to provide a Christ centered, comprehensive education for your child.
 - Be deliberate in displaying support for your student's teachers and administration in front of your student.
 - Please seek the "other side" before pressing "send".
 - Give your child space to make mistakes and learn from them; this is a "safe environment" to learn.
 - *Please*, set age-appropriate guidelines for technology at home.
-

Upcoming



- **Friday, August 6: Wolverine Welcome**
- **Monday, August 9: FIRST DAY OF SCHOOL**